

TENTATIVE TRACT NO. 37980

BEING A SURVEY OF THE EASTERLY HALF OF LOT 1 IN BLOCK 52 OF LANDS OF THE SOUTH RIVERSIDE LAND AND WATER COMPANY, AS SHOWN BY MAP FILED IN BOOK 9, PAGE 6 OF MAPS, RECORDS OF THE COUNTY OF SAN BERNARDINO, STATE OF CALIFORNIA, AND LYING WITHIN SECTION 36, TOWNSHIP 3 SOUTH, RANGE 7 WEST OF THE SAN BERNARDINO BASE AND MERIDIAN.

ACS CONSULTING, INC. OCTOBER 2021

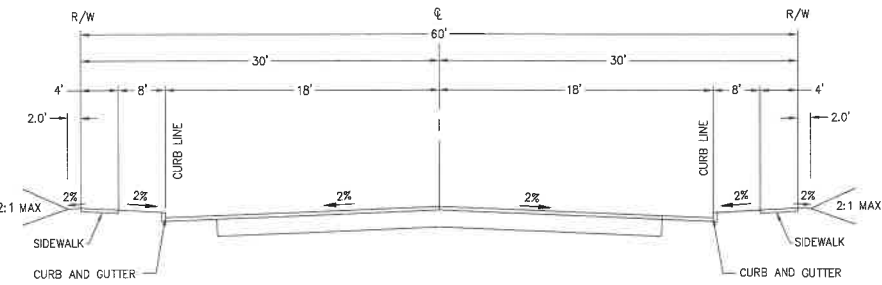

SUSANNE STREET/LORRAINE DRIVE

SCALE: NTS

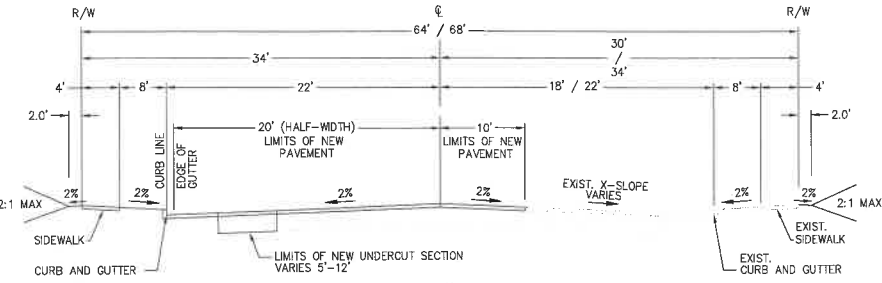

CITRON STREET/TAYLOR STREET

SCALE: NTS

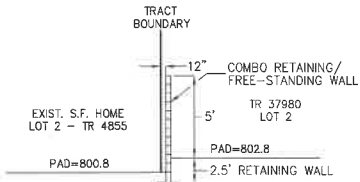

SECTION A-A

SCALE: NTS

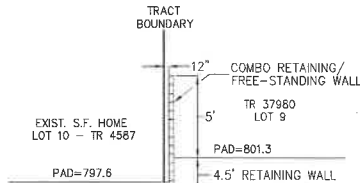

SECTION B-B

SCALE: NTS

CENTERLINE DATA				
NO.	BEARING/DELTA	RADIUS	LENGTH	TANGENT
A	D=04°14'37"	500.00'	37.02'	18.52'
B	N03°50'13"E	---	52.82'	---
C	D=04°14'37"	500.00'	37.03'	18.53'
D	N08°04'50"E	---	63.49'	---
E	D=90°01'34"	55.00'	86.42'	55.03'
F	N81°53'35"W	---	96.07'	---
REMARKS				
C/L				



PAVING NOTE: (") PAVING TO INCLUDE HALF-WIDTH OF ROAD (BOTH CITRON ST. AND TAYLOR ST.) + 10'



ACS CONSULTING, INC.
land planning, engineering, and surveying professionals
PO BOX 2252
TEMECULA CA 92593
TEL: 951-757-5178 e: frank@acsconsultinginc.com
PREPARED BY: FRANK A. ARTIGA R.C.E. NO. 61860
EXP. DATE: 09-30-23 DATE:

TENTATIVE TRACT NO. 37980
SITE PLAN/GRADING PLAN
CITY OF CORONA CA

REVISION BLOCK		
1	1st SUBMITTAL TO CITY	1-9-21
2	REVISIONS PER CITY COMMENT	10-7-21
REF.	DESCRIPTION	DATE