

## DOLLAR SS EXPANSION CONCEPT

By utilizing both hard and soft materials and employing texture, color, and plants of contrasting structure the resulting landscape will be a diverse, attractive addition to the project. Areas of meandering stone cobble and boulders will provide an enhanced transition between the built environment while providing interest and contrasting with the decorative plant material. The perimeter slope will be covered in a mulch and binding agent. The use of these materials will limit maintenance and watering needs. The plant palette is comprised of a diverse collection of California friendly, low maintenance, low water use trees and shrubs that will provide a range of colors, forms, and textures through its flowering perennials, bold succulents, and delicate ornamental grasses. The plants water needs will be served with a modern irrigation system in order to save water and irrigate at the source by utilizing dripline tubing to the shrubs and groundcover and bubblers to all trees.

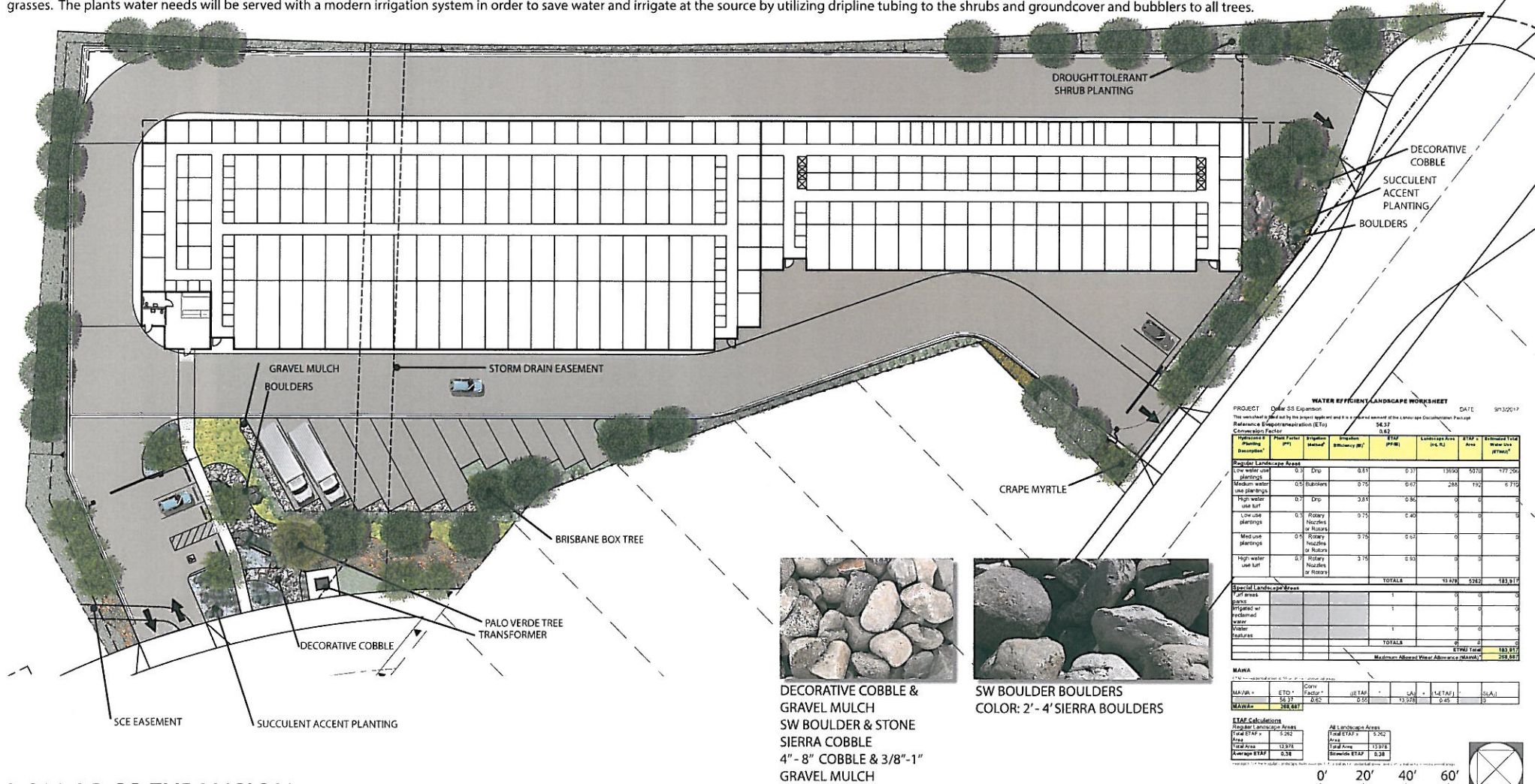

## DOLLAR SS EXPANSION



310 North Joy Street | Corona, CA 92879  
T: 951.737.1124 | F: 951.737.6551  
www.bmla.net

## CONCEPTUAL LANDSCAPE PLAN

PREPARED FOR VALLI ARCHITECTURAL GROUP  
27405 PUERTA REAL SUITE 235 MISSION VIEJO, CALIFORNIA T: (949) 813-4191  
DECEMBER 4, 2017



## Plant Palette

Mounding shrubs form the foundation of the planting and are punctuated by succulent accents and areas of decomposed granite and cobble with dramatic form. Evergreen groundcover provides a foreground frame for the succulent plantings.

Botanical Name	Common Name	Wucols	Size
<b>Succulent Accents</b>			
Agave desmettiana 'Variegata'	Variegated Smooth Agave	L	15g
Senecio 'Blue Chalk Sticks'	Senecio	L	1g
<b>Groundcover</b>			
Lantana x 'New Gold'	New Gold Lantana	L	1g
Myoporum parvifolium	Myoporum	L	1g
<b>Shrubs</b>			
Cistus x purpureus	Orchid Rockrose	L	5g
Hesperaloe parviflora	Red Yucca	L	5g
Leucophyllum cimarron	Cimarron	L	5g
Muhlenbergia capillaris	Pink Muhly	L	1g
Salvia g. 'Furman's Red'	Furman's Red Sage	L	5g
Salvia l. 'Santa Barbara'	Mexican Bush Sage	L	5g
<b>Trees</b>			
Cercidium x 'Desert Museum'	Desert Museum Palo Verde	L	36"box
Lagerstroemia indica	Crape Myrtle	M	36"box
Lophostemon confertus	Brisbane Box	M	24"Box

## Groundcover



Salvia g. 'Furman's Red'



Lantana x 'New Gold'



Myoporum parvifolium

## Accent



Agave desmettiana 'Variegata'

## Shrubs



Cistus x purpureus



Muhlenbergia capillaris



Lophostemon confertus



Senecio 'Blue Chalk Sticks'



Salvia leucantha 'Santa Barbara'



Leucophyllum cimarron



Hesperaloe parviflora



Lagerstroemia indica

## Trees



Cercidium x 'Desert Museum'

## DOLLAR SS EXPANSION



310 North Joy Street | Corona, CA 92879  
T: 951.737.1124 | F: 951.737.6551  
www.bmla.net

## PLANTPALETTE

PREPARED FOR VALLI ARCHITECTURAL GROUP  
27405 PUERTA REAL SUITE 235 MISSION VIEJO, CALIFORNIA T: (949) 813-4191  
DECEMBER 4, 2017