

- EXT. ELEVATION KEYNOTES**
1. ROOF DRAIN LINES DOWN COLUMN - DAYLIGHT AT GRADE - SEE DTL'S
 2. DASHED LINE INDICATES LINE OF ROOF DECK
 3. PROPOSED SIGNAGE (PROVIDE CONDUIT SLEEVE IN PANEL)
 4. PROPOSED ADDRESS SIGNAGE (12\"/>

MATERIAL SCHEDULE

NO.	ITEM
A	TILT-UP CONCRETE PANEL
B	METAL PANEL
C	STONEFRONT - CURTAINWALL
D	EXPANSION JOINTS
E	METAL (ALUMINUM) SUN SHADE
F	STOREFRONT
G	METAL ENTRY CANOPY
H	PANEL REVEAL
J	ARCHITECTURAL METAL PANEL
K	HOLLOW METAL DOOR/FRAME
L	STONE BASE
M	GLAZING
N	SPANDREL GLAZING

FINISH SCHEDULE

NO.	ITEM	MANUF.	COLOR
CP1	INTERIOR CONCRETE COLOR (HAND-BLASTED TEXTURE W/ CLEAR SEALER)	-	TO BE SELECTED
P1	PAINT	KELLY MOORE	TO BE SELECTED
P2	PAINT	KELLY MOORE	TO BE SELECTED
P3	PAINT	KELLY MOORE	TO BE SELECTED
P4	PAINT	KELLY MOORE	TO BE SELECTED
M1	STAINLESS PANEL	CUSTOM	#4 FINISH
M2	ALUMINUM SUN SHADE	AMERICALAD	ALUMINUM MILL FINISH
M3	PRE-FINISHED ALUMINUM PANEL	AMERICALAD AC2100	ALUMINUM MILL FINISH
R	METAL TRIM REVEAL	-	-
SF	STORE FRONT	KAWNEER	MILL FINISH
GL	GLAZING	P.P.G. GLASS	AZURIA SOLARBAN 70XL
SP	SPANDREL GLAZING	P.P.G. GLASS	MATCH GLAZING
ST	STONE	DAL-TILE	TO BE SELECTED

GENERAL NOTES

NOTE 1. PER SPECIFICATIONS SECTION 09100 PROVIDE A HIGH RIB LATH PRODUCT AT ALL HORIZONTAL APPLICATIONS

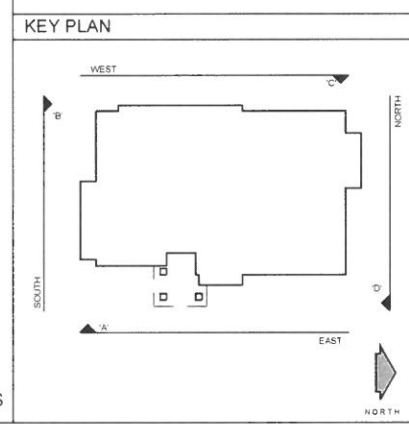

6121 North Theta #301, Fresno CA 93710
(P) 559-439-0700, (F) 559-439-0708
www.pings.com



Project Architect Approval:
Consultant:

Project Name:

Shell Building for:
Corona Medical Center
Medical Office Building
Building A
Sixth Street and Belle Avenue
Corona, Ca

Sheet Title:
Exterior Elevations

Project Number: 421 D
Project Contact: ANTHONY PINGS
Scale: AS NOTED

Issue Date:	Issue Description:
3-8-17	PRELIMINARY
12-13-18	DEVELOPMENT REVIEW
12-27-18	PLAN CHECK

PLAN CHECK

Revisions	Revision Date:
No.	

Drawing: **A3.2**
Sheet: of

